

**RESOLUTION NO. 16-04**

**A RESOLUTION OF THE BOARD OF TRUSTEES OF THE SPOKANE COUNTY LIBRARY DISTRICT, SPOKANE COUNTY, WASHINGTON, APPROVING THE FIRST AMENDMENT TO THE INTERLOCAL AGREEMENT BETWEEN THE CITY OF SPOKANE AND SPOKANE COUNTY LIBRARY DISTRICT CONCERNING MITIGATION OF THE IMPACT OF ANNEXATION IN MORAN PRAIRIE AND GLENROSE PRAIRIE; AUTHORIZING THE EXECUTION OF SUCH AMENDMENT; AND PROVIDING FOR OTHER MATTERS PROPERLY RELATED THERETO.**

**SPOKANE COUNTY LIBRARY DISTRICT  
Spokane County, Washington**

BE IT RESOLVED BY THE BOARD OF TRUSTEES OF THE SPOKANE COUNTY LIBRARY DISTRICT, SPOKANE COUNTY, WASHINGTON, as follows:

WHEREAS, the Spokane County Library District, Spokane County, Washington (the "Library District"), is a rural county library district duly organized and existing under and by virtue of the Constitution and the laws of the state of Washington;

WHEREAS, Spokane County, Washington (the "County") has created a library capital facilities area for the Moran Prairie approved by voters for the purpose of building the Moran Prairie Library;

WHEREAS, the City of Spokane and the Spokane County Library District entered into an interlocal agreement on December 13, 2004, concerning mitigation of the impact of annexation in Moran Prairie and Glenrose Prairie; and

Whereas, Section 1 of the interlocal agreement calls for an amendment to the agreement at the time of each future annexation of a portion of Moran Prairie Area, as defined in the interlocal agreement, to include a specific description of the proposed annexation area to be appended as an additional exhibit of the agreement; and

Whereas, there have been three annexations in the Moran Prairie Area, subsequent to the execution of the interlocal agreement; and

Whereas, the parties recognize and acknowledge that the City of Spokane has been paying and the Spokane County Library District has received payments for the amount of property tax the District would have been collecting each year if not for the annexations, as contemplated by the interlocal agreement for the Muirfield and Shopko annexations;

NOW, THEREFORE, IT IS HEREBY FOUND, DETERMINED AND ORDERED as follows:

**Section 1: Approval of First Amendment to the Interlocal Agreement**

This first amendment to the Interlocal Agreement between the City of Spokane and the Spokane County Library District concerning mitigation of the impact of annexation in Moran Prairie and Glenrose Prairie is approved and shall be attached to and incorporated into the agreement; and

**Section 2: Effective Date**

This Resolution shall be effective immediately upon its adoption.

ADOPTED by the Board of Trustees of Spokane County Library District, Spokane County, Washington, at a regular meeting thereof, held this 21<sup>st</sup> day of June 2016.

SPOKANE COUNTY LIBRARY DISTRICT  
Spokane County, Washington

  
\_\_\_\_\_  
Mark Johnson, Chair

ATTEST

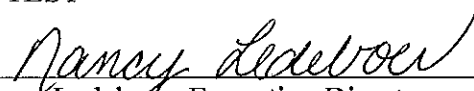
  
\_\_\_\_\_  
Nancy Ledebger, Executive Director and  
Secretary to the Board of Trustees

(S E A L)

\*\*\*\*\*

**CERTIFICATION**

I, Nancy Ledeboer, the acting Secretary of the Board of Trustees of Spokane County Library District, Spokane County, Washington, hereby certify that the foregoing resolution is a full, true and correct copy of a resolution duly passed and adopted at a regular meeting of the Board of Trustees of Spokane County Library District, duly held at the Argonne Library Public Meeting Room on June 21, 2016, of which all meeting members of such Board had due notice, and at which a majority thereof were present; and that at such meeting such resolution was adopted by the following vote:

AYES, and in favor thereof, Trustees: Mark Johnson, John Craig, Sonja Carlson, Wesley Teterud, and Kristin Thompson.

NAYS, Trustees:

ABSENT, Trustees:

ABSTAIN, Trustees:

I further certify that I have carefully compared the same with the original resolution on file and of record in my office; that such resolution is a full, true and correct copy of the original resolution adopted at such meeting; and that such resolution has not been amended, modified, or rescinded since the date of its adoption, and is now in full force and effect.

IN WITNESS WHEREOF, I have set my hand on this 21<sup>st</sup> day of June 2016.

SPOKANE COUNTY LIBRARY DISTRICT  
Spokane County, Washington

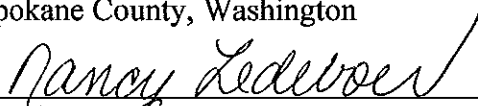
  
\_\_\_\_\_  
Nancy Ledeboer, Secretary to the Board of Trustees

(S E A L)

**FIRST AMENDMENT TO INTERLOCAL AGREEMENT  
BETWEEN THE CITY OF SPOKANE  
AND THE SPOKANE COUNTY LIBRARY DISTRICT  
CONCERNING MITIGATION OF THE IMPACT  
OF ANNEXATION IN MORAN PRAIRIE AND GLENROSE PRAIRIE**

WHEREAS, the City of Spokane and the Spokane County Library District entered into an interlocal agreement on December 13, 2004, concerning mitigation of the impact of annexation in Moran Prairie and Glenrose Prairie; and

WHEREAS, Section 1 of the Interlocal Agreement calls for an amendment to the agreement at the time of each future annexation of a portion of the Moran Prairie Area, as defined in the Interlocal Agreement, to include a specific description of the proposed annexation area to be appended as an additional exhibit of the agreement; and

WHEREAS, there have been three annexations in the Moran Prairie Area, subsequent to the execution of the Interlocal Agreement; and

WHEREAS, the parties recognize and acknowledge that the City of Spokane has been paying and the Spokane Library District has been receiving payments for the amount of property tax the District would have been collecting each year if not for the annexations as contemplated by the Interlocal Agreement for the Muirfield and Shopko annexations; and

NOW, THEREFORE, this First Amendment to the Interlocal Agreement between the City of Spokane and the Spokane County Library District concerning mitigation of the impact of annexation in Moran Prairie and Glenrose Prairie shall be attached to and incorporated into the agreement.

The Interlocal Agreement is amended to include the following annexations:

Descriptions of the Muirfield, Shopko and Spokane Housing Ventures annexations are incorporated as Attachments A, B, and C respectively, including the legal descriptions and maps.

Attachment A: Muirfield Annexation approved by the City Council on February 7, 2005, pursuant to Ordinance No. C – 33585. City Council approved Resolution No.2004-0081 on August 23, 2004, to pursue the annexation, which was initiative by the petition method under Chapter 35.13 RCW.

Attachment B: Shopko Annexation approved by the City Council on February 28, 2005, pursuant to Ordinance No. C – 33597. City Council approved Resolution No. 04-82 on August 23, 2004, to pursue the annexation, which was initiative by the petition method under Chapter 35.13 RCW.

Attachment C: Spokane Housing Ventures Annexation approved by the City Council on April 11, 2016, pursuant to Ordinance No. C – 35370. City Council approved Resolution No. 2015 - 0031 on April 20, 2015, to pursue the annexation, which was initiative by the petition method under Chapter 35.13 RCW.

ACCEPTED AND AGREED TO ON \_\_\_\_\_

SPOKANE COUNTY LIBRARY DISTRICT

Board of Trustees

By:   
Its: Chairperson – Mark Johnson

Approved as to form:

By:   
Its: Counsel to the Library District

CITY OF SPOKANE

By: \_\_\_\_\_  
Its:

Attest:

\_\_\_\_\_  
City Clerk

SPOKANE PUBLIC LIBRARY

By: \_\_\_\_\_  
Its: Library Director

Approved as to form:

By: \_\_\_\_\_  
Its: Assistant City Attorney

ATTACHMENT A – MUIRFIELD ANNEXATION LEGAL DESCRIPTION AND MAP

LEGAL DESCRIPTION:

That portion of the South half of Section 35, Township 25 North, Range 43 East, W.M. generally situated between 37<sup>th</sup> avenue and 42<sup>nd</sup> Avenue extended, being approximately 780 feet wide as measured in an east-west direction, and adjoining the East limit of the City of Spokane as established on 11/6/89; MORE SPECIFICALLY DESCRIBED AS FOLLOWS:

The entire area contained solely within Muirfield Addition and Muirfield First Addition, including all of 37<sup>th</sup> Avenue adjoining the North plat boundary line of Muirfield Addition.

All properties situate in Spokane County, Washington.

# Muinfield Annexation Map

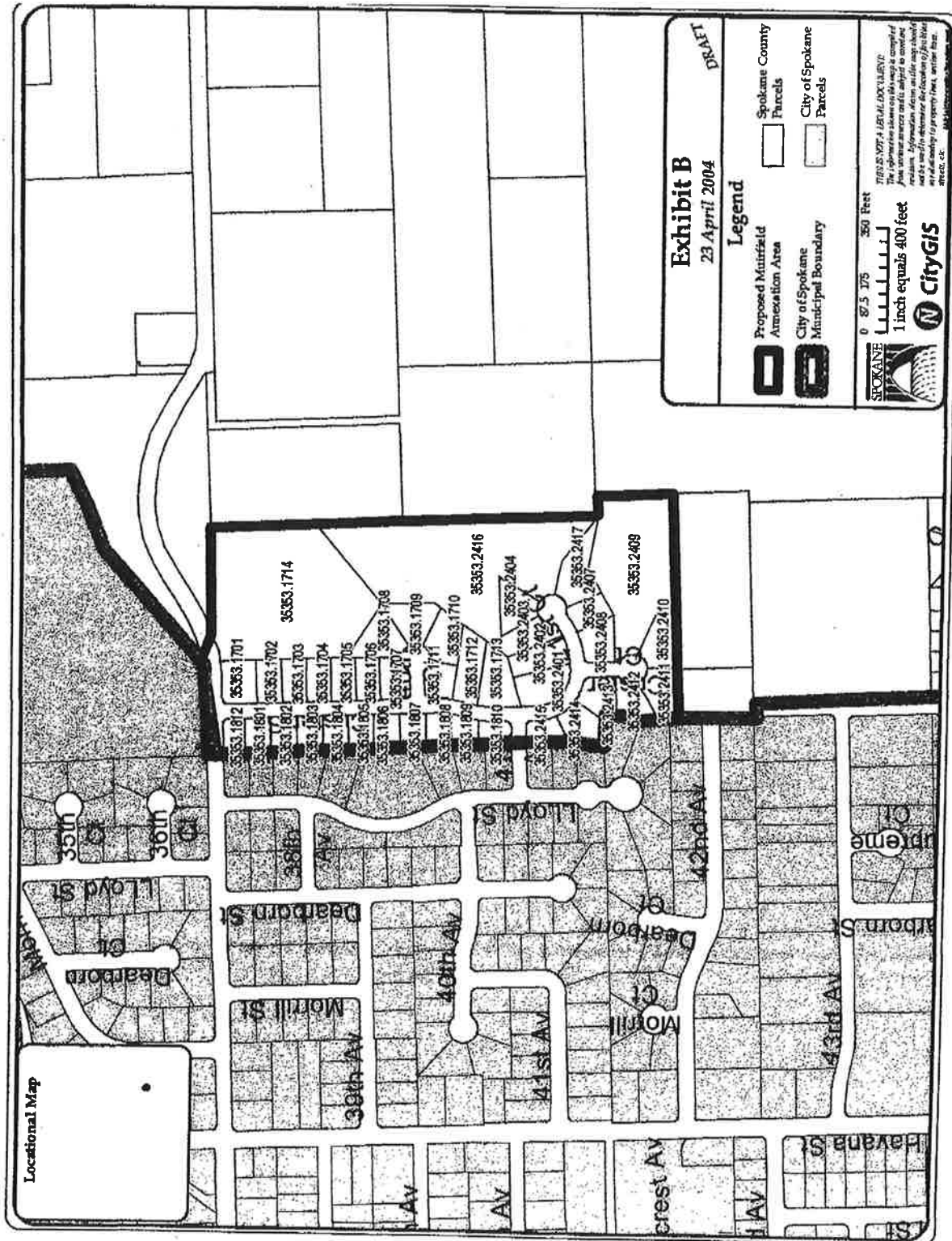

Locational Map

**Exhibit B**  
 23 April 2004  
 DRAFT

**Legend**

- Proposed Muinfield Annexation Area
- Spokane County Parcels
- City of Spokane Municipal Boundary
- City of Spokane Parcels

0 87.5 175 350 Feet  
 1 inch equals 400 feet

CityGIS

THIS IS NOT A LEGAL DOCUMENT. The information shown on this map is compiled from various sources and is not intended to be used as a legal document. Information shown on this map is not a warranty or representation of any kind. Spokane County, WA

ATTACHMENT B – SHOPKO ANNEXATION LEGAL DESCRIPTION AND MAP

LEGAL DESCRIPTION:

A. That portion of Section 3, Township 24 North, Range 43 East, W.M. described as follows:

1. That portion of Government Log 3 lying westerly of the west line of Freya Street.
2. All of Government Lot 4, and that portion of Government Lot 5 lying north of the south 20 rods of said Government Lot 5 and northeasterly of the centerline of vacated Palouse Highway.
3. That portion of the south 20 rods of said Government Lot 5 lying northeasterly of the Palouse Highway, including Palouse Highway southwesterly of and adjoining.
4. That portion of Government Lots 6 and 11 lying westerly of the west line of Freya Street; including all of Freya Street adjoining the west lines of Ashton Heights 2<sup>nd</sup> and 3<sup>rd</sup> Additions north of the Palouse Highway; including all of Freya Street adjoining the east line of Russell's Subdivision south of the Palouse Highway.
5. All of Government Lot 12, including that portion of 53<sup>rd</sup> Avenue south of and adjoining; including Regal Street west of and adjoining.

And:

B. That portion of Section 4, Township 24 North, Range 43 East, W.M. described as follows:

1. All of Government Lots 9 and 10, EXCEPT that portion contained within Crestline Court subdivision; including Crestline Street west of and adjoining said property; including 53<sup>rd</sup> Avenue south of and adjoining said property, including Regal Street east of and adjoining.
2. That portion of Government Lot 1 lying within fractional northeast  $\frac{1}{4}$  and lying easterly of Regal Road and Palouse Highway.

All properties situate in Spokane County, Washington.



# Shopco Annexation Map

## BRB 583-04: Proposed Annexation to the City of Spokane (Shopko)

Annexation Area approved by the Boundary Review Board  
on November 8, 2004

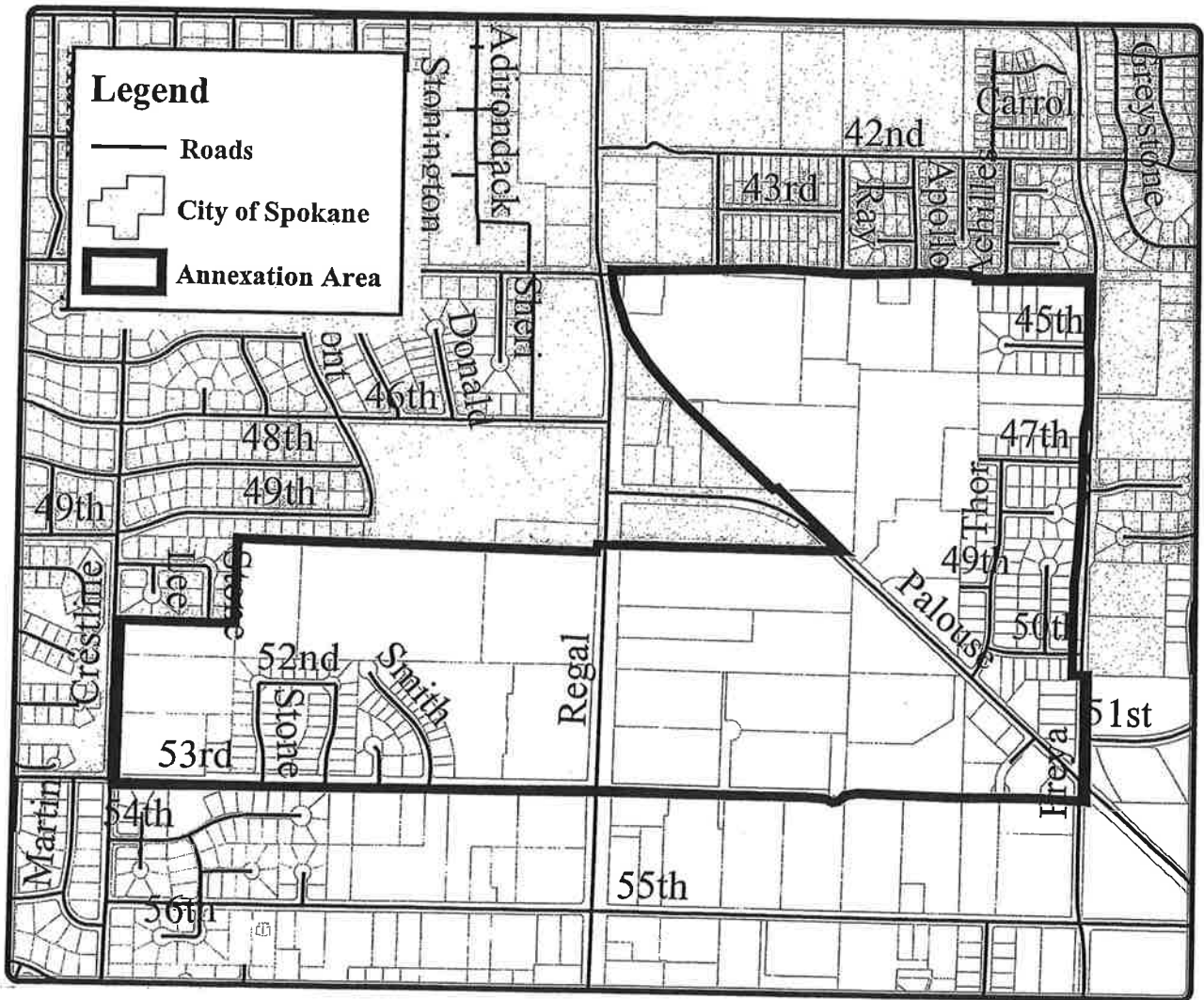

ATTACHMENT C – SPOKANE HOUSING VENTURES ANNEXATION LEGAL DESCRIPTION AND MAP

LEGAL DESCRIPTION:

Those portions of the North ½ of Section 3, Township 24 North, Range 43 East W.M. and further described as follows:

All of lots 5-7 and portions of lots 3,4 and 8-12 of, Block 1, of The Amended Plat of South Spokane and Lot 1, Block 2, of the Plat of Hilby Station; which include the following Parcel Numbers: 34032.0433, 34032.0405, 34032.0432, 34032.0490, 34032.0489, 34032.0492, 34032.0481, 34032.0480, 34032.0446, 34032.0412, and 34032.0447.

The boundaries are described below:

Beginning (Point of Beginning) at the southwest corner of Lot 12, Block 1, of The Amended Plat of South Spokane, which is also the intersection of the north right-of-way line of 55<sup>th</sup> Avenue and the east right-of-way line of Regal Street; THENCE west across Regal Street to the intersection of the west right-of-way line of Regal Street and the north right-of-way line of 55<sup>th</sup> Avenue; THENCE north along said west right-of-way line of Regal Street to the intersection of the south right-of-way line of 53<sup>rd</sup> Avenue (coincident with the south limit of the City of Spokane) and the west right-of-way line of Regal Street; THENCE east along the south limit of the City of Spokane to the southeast corner of Lot 1 Block 2 of the plat of Russell's subdivision recorded at the Spokane County Auditor on October 11, 1962, said point being on the west right-of-way line of Freya Street; THENCE east across Freya Street to the intersection of the east right-of-way line of Freya Street and the north line of Lot 4 Block 1 of the Amended Plat of South Spokane; THENCE south along the east right-of-way line of Freya Street to the intersection of the north right-of-way line of 55<sup>th</sup> Avenue and the east right-of-way line of Freya Street; THENCE west across Freya Street to the intersection of the north right-of-way line of 55<sup>th</sup> Avenue and the west right-of-way line of Freya Street; THENCE west along the north right-of-way line of 55<sup>th</sup> Avenue to the point of beginning.

All properties situated in Spokane County, Washington.

# Spokane Housing Ventures Annexation Map

